

STREET LEVEL FLOOR PLAN

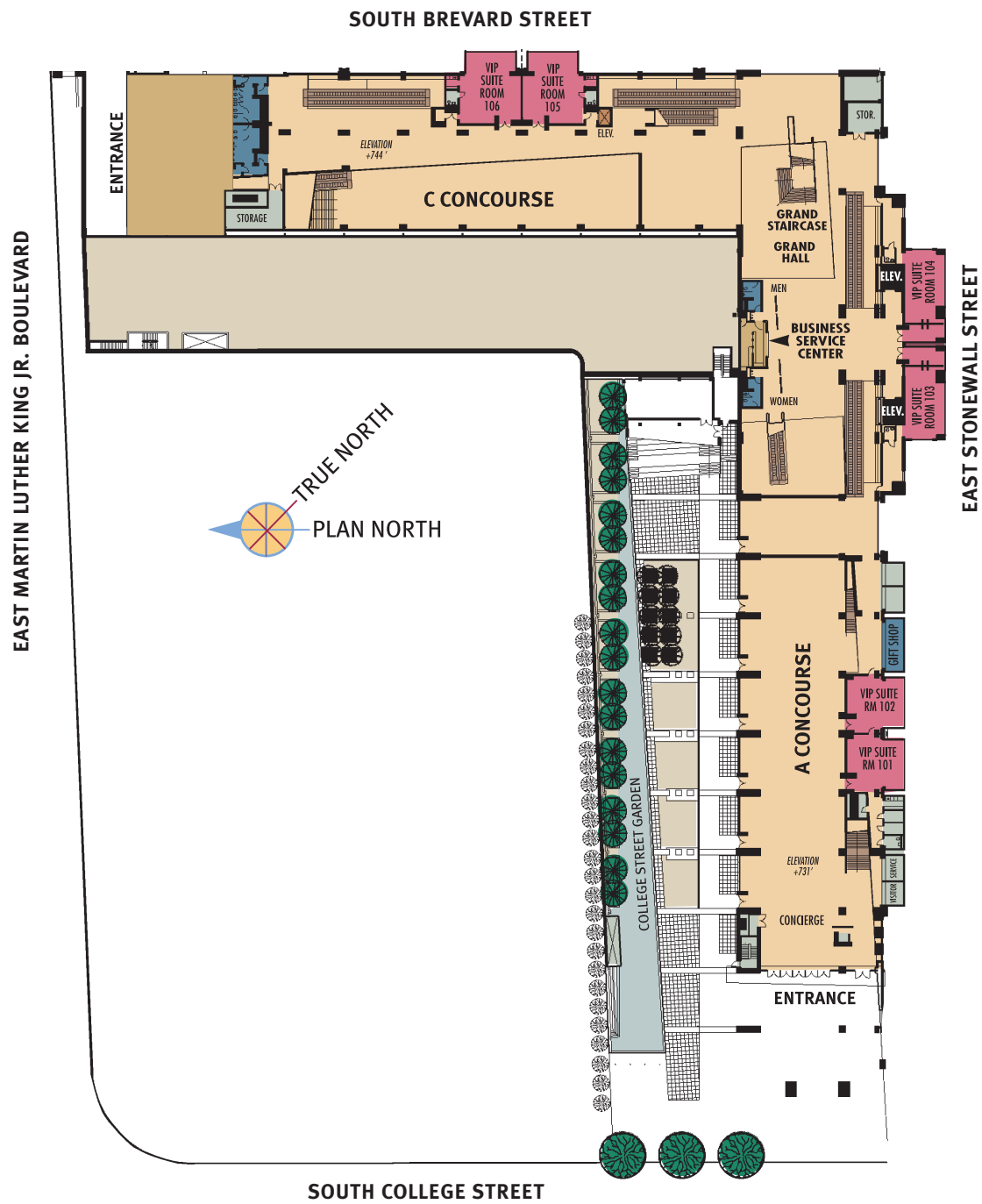
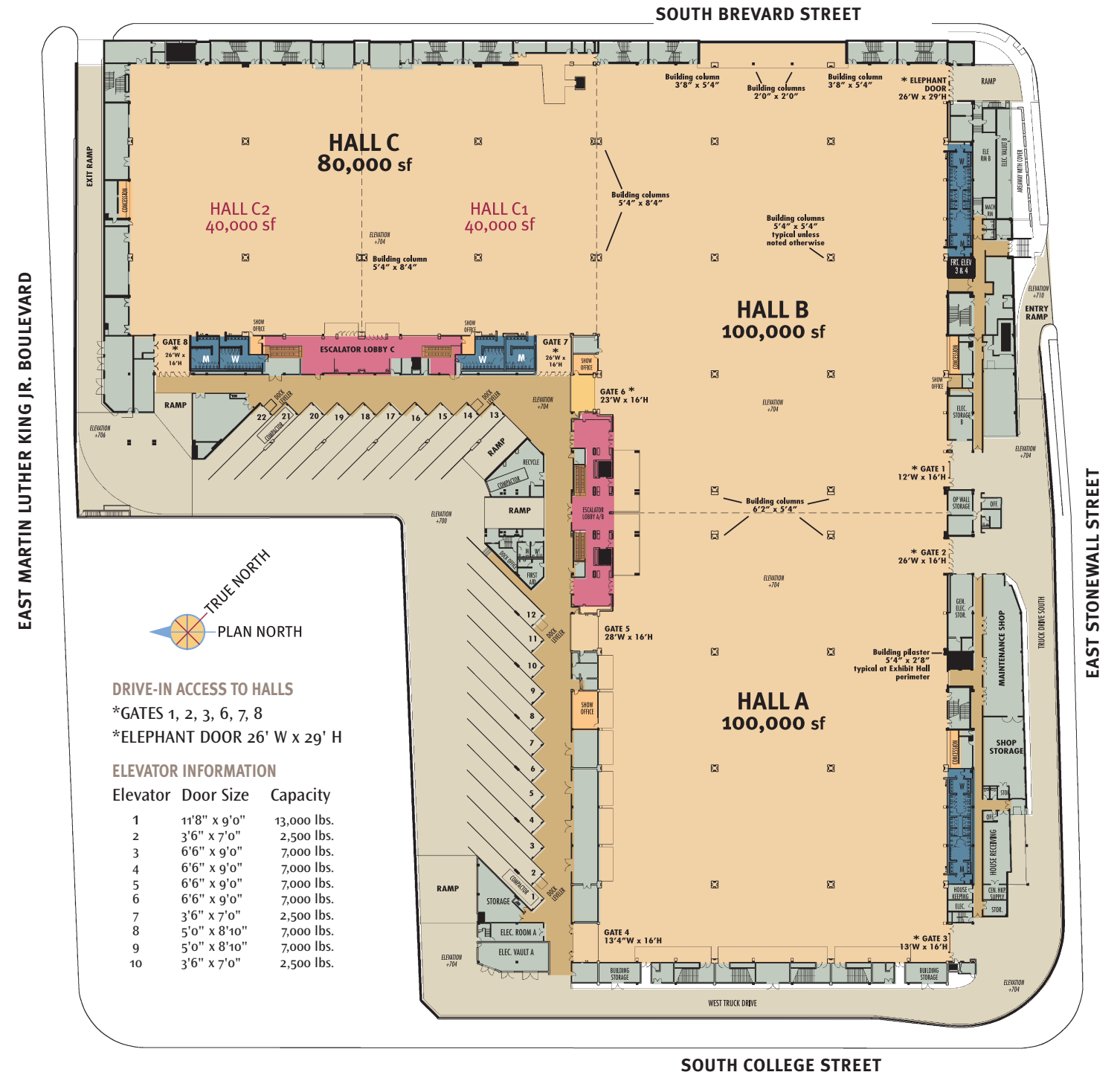

EXHIBIT LEVEL FLOOR PLAN



- DRIVE-IN ACCESS TO HALLS**
 *GATES 1, 2, 3, 6, 7, 8
 *ELEPHANT DOOR 26' W x 29' H
- ELEVATOR INFORMATION**
- | Elevator | Door Size | Capacity |
|----------|--------------|-------------|
| 1 | 11'8" x 9'0" | 13,000 lbs. |
| 2 | 3'6" x 7'0" | 2,500 lbs. |
| 3 | 6'6" x 9'0" | 7,000 lbs. |
| 4 | 6'6" x 9'0" | 7,000 lbs. |
| 5 | 6'6" x 9'0" | 7,000 lbs. |
| 6 | 6'6" x 9'0" | 7,000 lbs. |
| 7 | 3'6" x 7'0" | 2,500 lbs. |
| 8 | 5'0" x 8'10" | 7,000 lbs. |
| 9 | 5'0" x 8'10" | 7,000 lbs. |
| 10 | 3'6" x 7'0" | 2,500 lbs. |

STREET LEVEL	SQUARE FEET	CEILING	THEATRE	BANQUET	RECEPTION	CLASSROOM
101 VIP Suite	797	9'	72	44	80	N/A
102 VIP Suite	797	9'	72	44	80	N/A
103 VIP Suite	908	9'	72	44	80	N/A
104 VIP Suite	908	9'	72	44	80	N/A
105 VIP Suite	1,118	9'	117	38	112	N/A
106 VIP Suite	1,124	9'	117	38	112	N/A

STREET LEVEL	SQUARE FEET	CEILING	THEATRE	BANQUET	RECEPTION	CLASSROOM
Registration (A & C Concourses)	43,000	N/A	N/A	N/A	N/A	N/A
College Street Garden	19,600	N/A	N/A	N/A	1,000	N/A
Visitors Services (Includes business center and visitors services)	1,300	N/A	N/A	N/A	N/A	N/A

EXHIBIT HALL	SQUARE FEET	CEILING	THEATRE	BANQUET	RECEPTION	CLASSROOM	BOOTH 40x10
Exhibit Hall A, B & C	280,000	30'	N/A	N/A	N/A	N/A	1,250
Hall A	100,000	30'	N/A	4,000	N/A	N/A	450
Hall B	100,000	30'	N/A	4,000	N/A	N/A	450
Hall A & B	200,000	30'	N/A	8,000	N/A	N/A	900

EXHIBIT HALL	SQUARE FEET	CEILING	THEATRE	BANQUET	RECEPTION	CLASSROOM	BOOTH 40x10
Hall B & C	180,000	30'	N/A	6,800	N/A	N/A	800
Hall C	80,000	30'	6,000	2,800	4,000	3,800	350
Hall C1	40,000	30'	2,500	1,400	2,400	1,900	175
Hall C2	40,000	30'	2,500	1,400	2,400	1,900	175